

CALIBRATING THE AIR FLOW ON YOUR INSPECTION CART

YOUR INSPECTION CART IS CALIBRATED BEFORE SHIPPING,
BUT IF YOU ARE CONCERNED ABOUT THE ACCURACY OF THE MEASUREMENTS
DO THE FOLLOWING:

1. REMOVE THE LEFT SIDE PANEL TO EXPOSE THE BLOWER.
2. PLACE FLOW CALIBRATION PLATE ④ OVER THE FLOW TEST PORT ON THE TABLE TOP.
3. TURN ON THE BLOWER.
4. CHECK TO SEE IF THE DISPLAY MEASURES 2.5 inWC.
5. IF OUT OF CALIBRATION, LOOSEN WINGNUTS ③ ON THE FLOW OUTLET PLATE ① AND ADJUST UNTIL IT READS 2.5 inWC.
6. TIGHTEN WINGNUTS TO SECURE FLOW OUTLET PLATE ① IN PLACE.
7. VERIFY THE READING BEFORE TURNING OFF THE BLOWER AND REMOVING THE FLOW CALIBRATION PLATE ④.

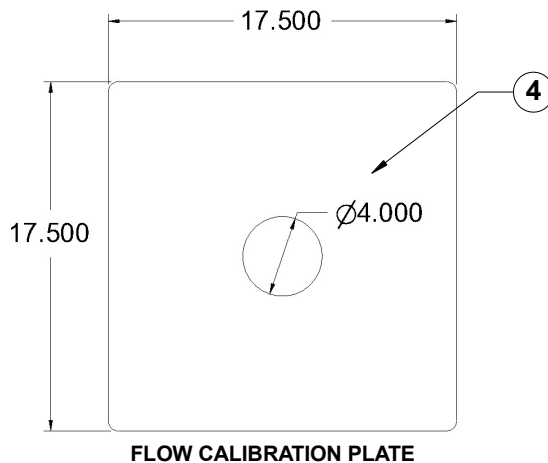

#	Part Name
1	FLOW OUTLET PLATE
2	BLOWER
3	WINGNUT
4	FLOW CALIBRATION PLATE

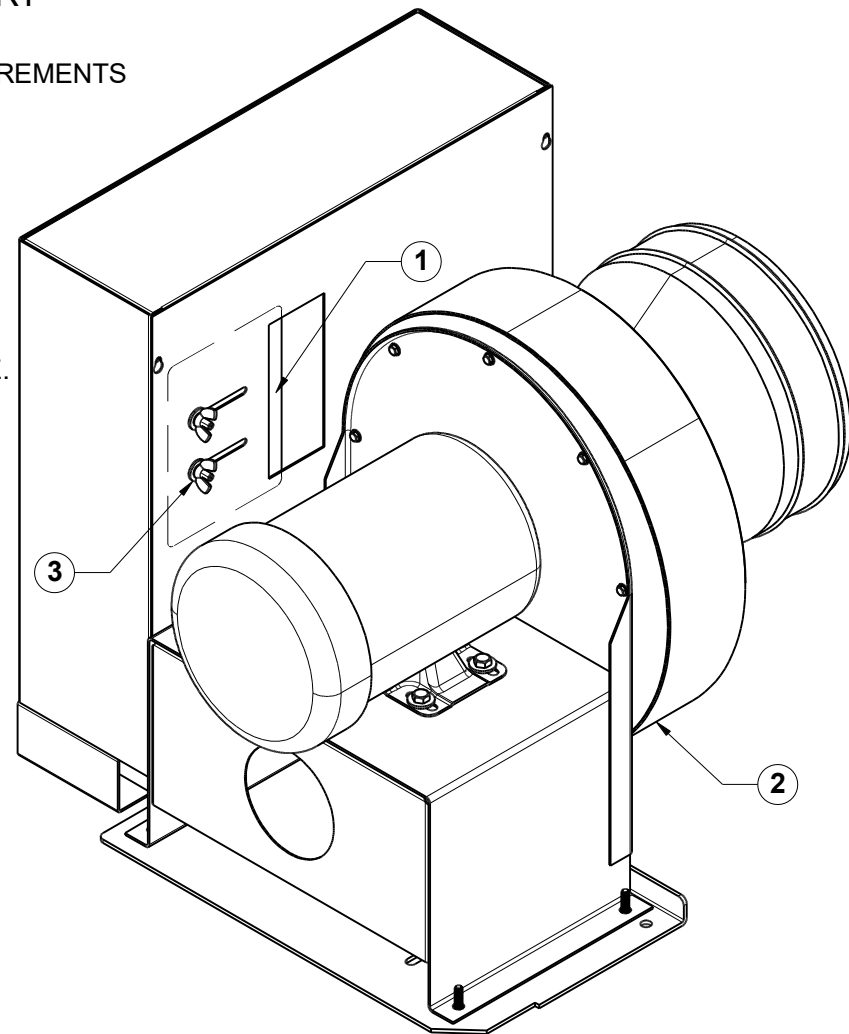

DIESEL EMISSIONS SERVICE 16435 CLEAR CREEK RD REDDING, CA 96001 530-241-3950 www.DES.direct	DRAWN	DATE	TITLE AIR FLOW CALIBRATION	
	CHECKED	APPROVAL DATE		
THIS DRAWING IS THE PROPERTY OF DIESEL EMISSIONS SERVICE (DES). THIS DRAWING MAY NOT BE REPRODUCED OR DISCLOSED TO A THIRD PARTY WITHOUT WRITTEN DES PERMISSION.			MATERIAL	
	TOLERANCES LINEAR: $\pm 1/16"$ HOLE: $\pm 1/64"$ DIA ANGULAR: $\pm 1^\circ$		SIZE A	DWG NO. MFG101986
	SCALE 1:6 OR NOTED		SHEET 1 of 1	REV -0